

## MGL Avionics Servo Connecting Rod Assembly

As an additional optional extra an installation kit can be ordered from your local MGL Avionics distributor. One standard metric installation kit contains the necessary parts to connect one servo to one actuator.

The Rod End Pieces have been designed to be compatible with imperial standard tubes. If longer lengths of tube are required, the supplied tube can be replaced with a longer length of 0.5" outside diameter (0.402" ID) 6061 T6 Aluminum obtainable from companies like Aircraft Spruce.

### Connecting Rod Kit Packing List

The standard metric optional extra installation kit contains the following:

- 1 x 300mm x 10.3mm ID / 12.7mm OD 6063 Aluminum Tube
- 2 x M5 Rose Joint / End Bolt Bearing (1 x LH & 1 x RH thread)
- 2 x M5 Female Rod End Piece (1 x LH & 1 x RH thread)
- 2 x M5 Nuts (1 x LH & 1 x RH thread)
- 4 x Solid Aluminum Rivets

### Assembling the Connecting Rod

The first step is to cut the tube to length, and then mark the locations of the two rivets to be mounted perpendicular to each other. Once the tube has been cut to length, the female rod end pieces are inserted into the tube, drilled in place and then rivitted.



*Completed Rod Assembly*

M5 Female Rod End Piece diagram (Side Cross Section):

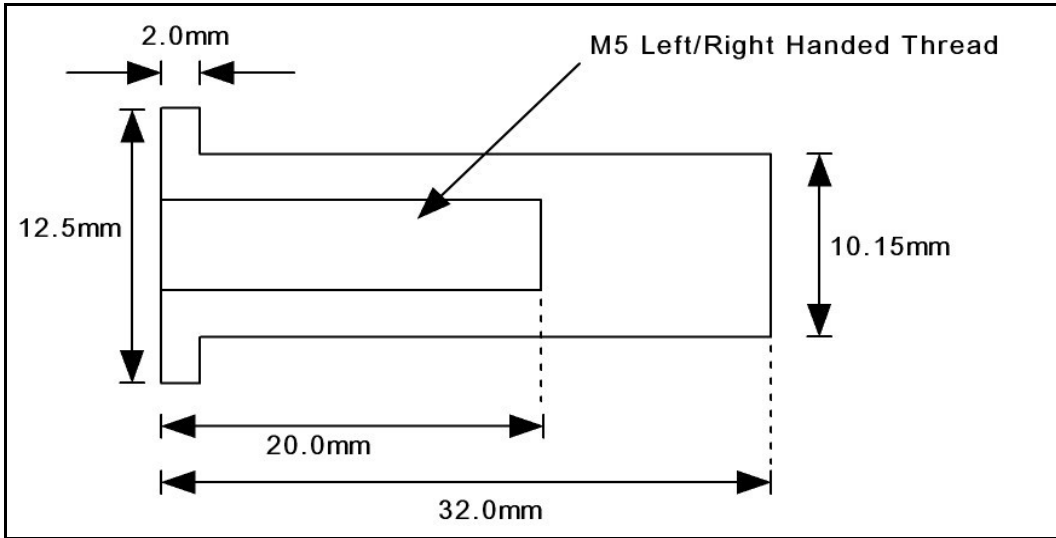

Drill Dimensions:

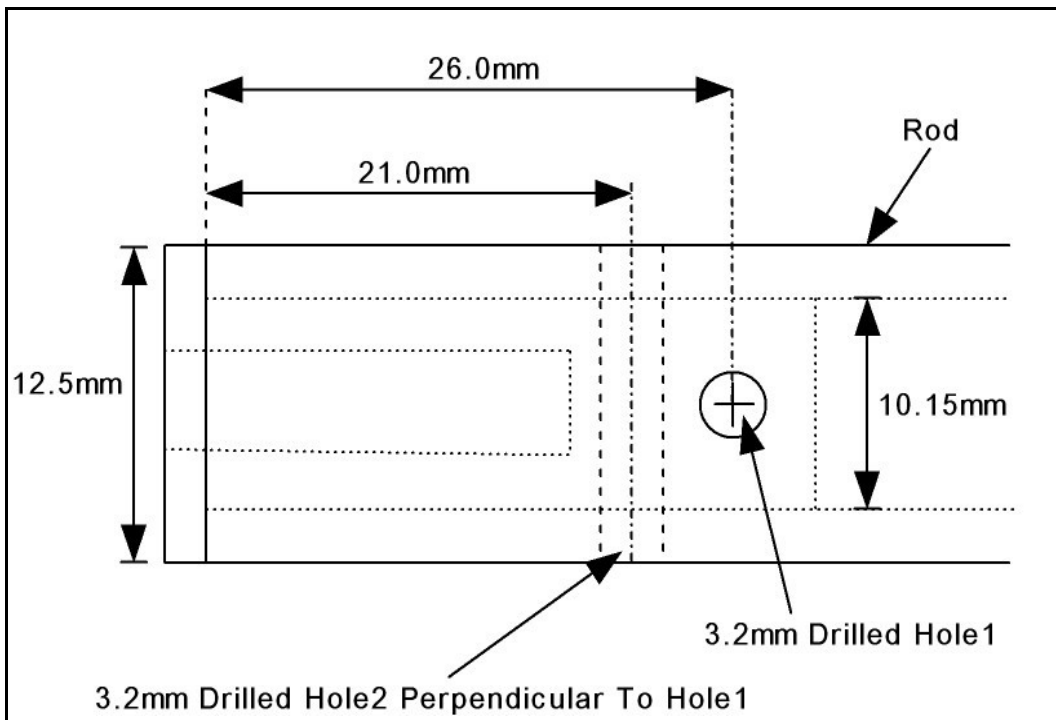

Mark the two holes based on the figures on the previous page describing the dimensions of the parts:

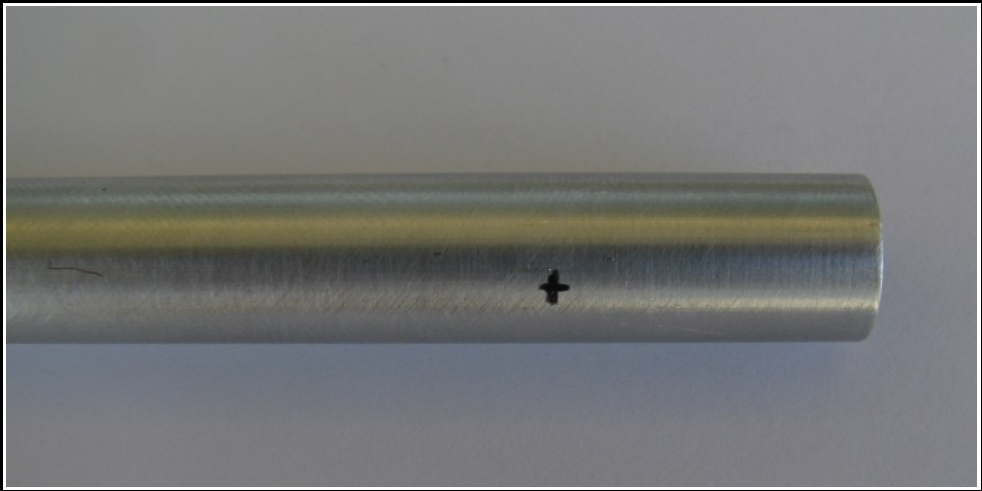

Drill the two perpendicular rivet holes to secure the M5 Female Rod End Pieces:



Insert and pop the two rivets:



Repeat the above for both ends. Result:

